

# Plexo™ Switches and two-ways

Cat. Nos.: 0 695 11/12/13/15/16/19/21/24/25/26/30/31/32/38  
 0 696 11/12/13/15/19/25/26/27/29  
 0 697 10/11/12/13/14/15/16/17/18/51/52/53/54/55/56/58  
 0 698 11/12/17/51/52/55/56  
 0 707 11/26/27

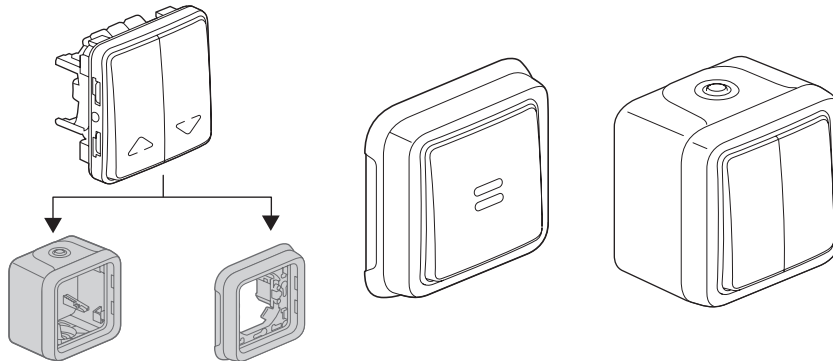

## 1. USE

Weatherproof wiring devices system intended for residential and professional technical premises (garages, cellars, car parks, workshops and industrial kitchens, etc.) as well as outdoor environments (patios, terraces, gardens, camping sites, etc.).  
 Lighting control mechanisms with or without indicating (lights) or signalling (marking) components.

## 2. RANGE

2 versions : grey and white		References
<b>Configurable</b>		0 695 11/12/13/15/16/19/21/25/26/30/31/32/38 0 696 11/12/13/15/19/25/26/27/29 0 707 11/26/27
<b>Surface-mounting complete</b>		0 697 10/11/12/13/14/15/16/17/18 0 697 51/52/53/54/55/56/58
<b>Flush-mounting complete</b>		0 698 11/12/17 0 698 51/52/55/56

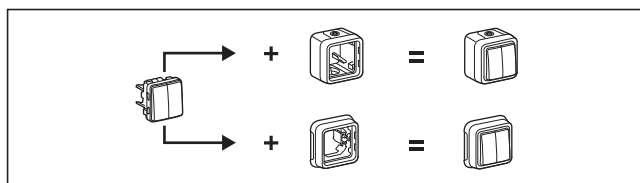

## 3. PREPARATION

### 3.1 Surface-mounting

- By screwing the base box onto the support using 2 screws Ø 3-4 mm max.

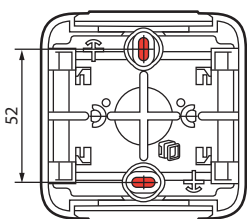

## 3. PREPARATION (continued)

### 3.2 Flush-mounting

- Frame dismantling

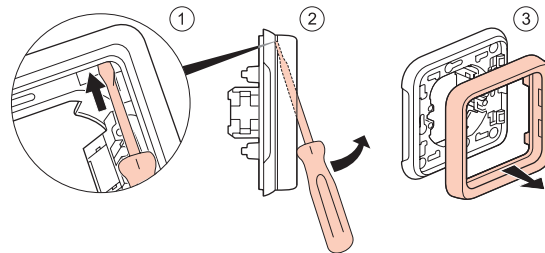

- By screwing onto a flush-mounting box

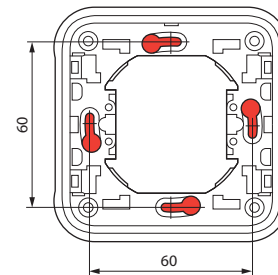

- By claws onto a flush-mounting box

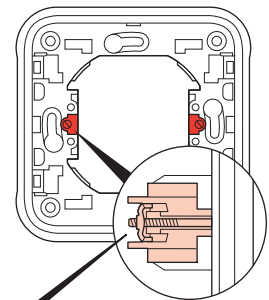

Possibility to place claws:  
 Cat. No. 0 849 00 or Cat. No. 0 849 01 (long claw)

- By face plate using 4 screws Ø 4 mm

Piercing of support material for diameter 60-70 mm using cylinder saw or punch.

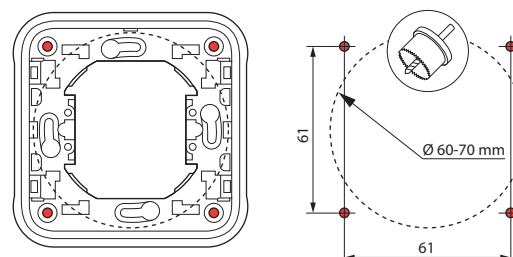

#### 4. OVERALL DIMENSIONS (mm)

##### ■ Configurable

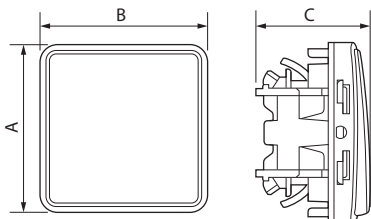

##### ■ Surface-mounting

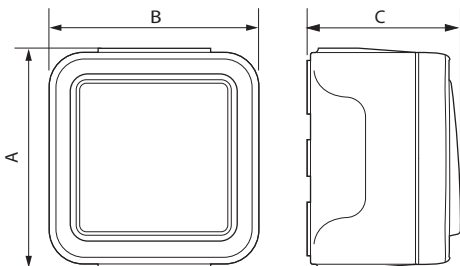

##### ■ Flush-mounting

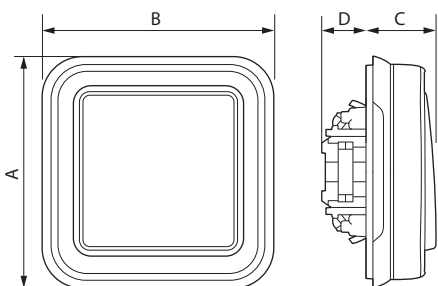

	A	B	C	D
<b>Configurable</b>	64	64	40	-
<b>Surface-mounting</b>	84	80	57	-
<b>Flush-mounting</b>	86	86	23	19

#### 5. CONNECTION

##### ■ Connection to conductors

• 1 break

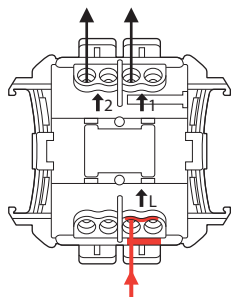

• 2 breaks

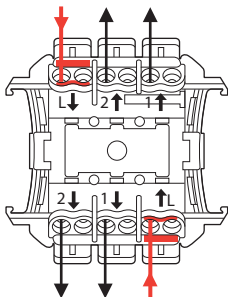

#### 5. CONNECTION (continued)

##### ■ Connection to conductors

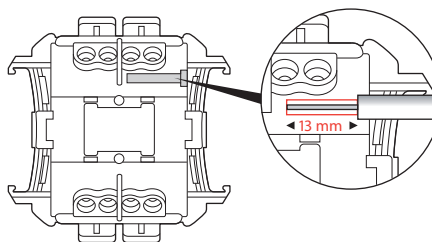

Type of terminals: automatic  
Terminal capacity: 1.5 mm<sup>2</sup> - 2.5 mm<sup>2</sup> (1 or 2 conductors)  
Stripping length: 13 mm

#### 6. TECHNICAL CHARACTERISTICS

##### ■ 6.1 Protection index

Protection against solid bodies and liquids: IP 55  
Protection against impact: IK 07

##### ■ 6.2 Material characteristics

Box, support: PP reinforced  
Front plate, rocker: ABS  
Entry gland, cover plate: PP + SEBS  
Mechanism: PC  
UV resistant  
Resistance to salt spray: 7 days (168 h)  
Self-extinguishing:  
+ 850°C / 30 s for insulating components holding in place live parts.  
+ 650°C / 30 s for the other insulating components.

##### ■ 6.3 Electrical characteristics

Current: 10 AX  
6 AX for Cat. Nos. 0 695 15 - 0 696 15  
Voltage: 250 V~  
Frequency: 50 Hz

##### ■ 6.4 Climatic characteristics

Storage temperature: - 25° C to + 70° C  
Use temperature: - 20° C à + 40° C

#### 7. CLEANING

Surface cleaning with dry cloth or cloth dipped in soapy water.  
Do not use acetone, tar remover or trichloroethylene.

**Caution:** A test should be carried out before using any specific cleaners.

#### 9. STANDARDS AND APPROVALS

Compliance with standards of installation and manufacturing.  
Refer to e. catalogue.

# Plexo™

## Switches and push-buttons with indicator lights

Cat. No(s): 0 695 12/13/14/15/19/26/31/32/42/43/44/46  
 0 696 12/13/14/15/19/26/32/33/34/36  
 0 697 10/12/13/22/23  
 0 698 21/24/61/64

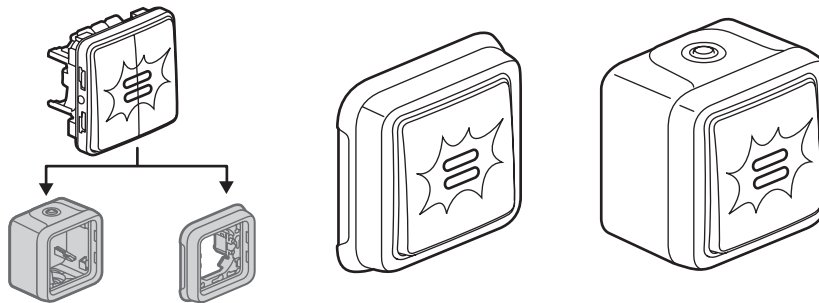

### 1. USE

Lighting control mechanisms with indicator/locator lights.  
 Products are delivered with lamps fitted.

### 2. RANGE

Cat. No(s)	2 versions: Grey and White
0 695 xx 0 696 xx	Modular mechanisms
0 697 xx 0 698 xx	Surface-mounting, supplied complete Flush-mounting, supplied complete

### 3. DIMENSIONS (mm)

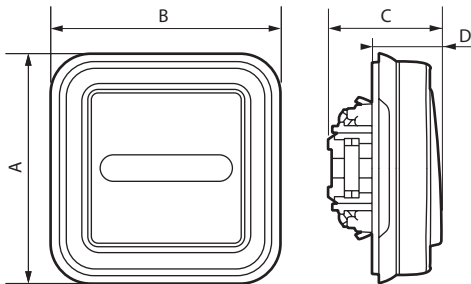

Cat. No(s)	A	B	C	D
0 695 12/13/14/15/31/32/42 0 696 12/13/14/15/32 0 695 43/44 - 0 696 33/34 0 695 19/26/36 - 0 696 19/26/36	64	64	40	-
0 697 10/12/13/22/23	84	80	57	-
0 698 21/61 0 698 24/64	86	86	42	23

### 4. CONNECTION

Type of terminals: automatic  
 Terminals capacity: 2 x 1.5 mm<sup>2</sup> - 2 x 2.5 mm<sup>2</sup>  
 Stripping length: 13 mm

### 5. TECHNICAL CHARACTERISTICS

#### 5.1 Mechanical characteristics

Protection against impact: IK 07  
 Protection against solid/bodies and liquids: IP 55

#### 5.2 Material characteristics

Box, support: PP (reinforced polypropylene)  
 Front plate, rocker: ABS  
 Entry gland, cover plate: PP + SEBS  
 Mechanism: PC  
 UV resistant  
 Resistance to salt spray: 7 days (168 h)  
 Colours: Grey matt RAL 7046  
 White matt RAL 9114

#### Self-extinguishing:

850°C / 30 s for insulating components holding in place live parts.  
 650°C / 30 s for the other insulating components

#### 5.3 Electrical characteristics

Voltage: 230 V~  
 Frequency: 50 Hz

Designation	References	Characteristics	Locator	Indicator
MODULAR MECHANISMS	0 695 42 - 0 696 32	10 A	█	
	0 695 13/31 - 0 696 13	10 AX	█	
	0 695 15 - 0 696 15	6 AX		█
	0 695 12/14/32 - 0 696 12/14	10 AX		█
MODULAR MECHANISMS	0 695 43 - 0 696 33	12 V	█	
	0 695 44 - 0 696 34	12 V	█	
	0 695 26 - 0 696 26 0 695 19 - 0 696 19 0 695 46 - 0 696 36	10 AX 10 A - 10 AX 10 A	█ █ █	
SUPPLIED COMPLETE	0 697 10/12 0 697 13 0 697 22 0 697 23	10 AX 10 AX 10 A 10 A	█ █ █ █	█  █
	0 698 21/61	10 A	█	
	0 698 24/64	12 V or 230 V~ (with 230 V lamp)	█	

Locator █ green fluorescent lamp  
 Indicator █ orange neon lamp

## 5. TECHNICAL CHARACTERISTICS *(continued)*

### ■ 5.4 Climatic characteristics

Storage temperature: - 25° C to + 70° C

Use temperature: - 25° C to + 40° C

## 6. CLEANING

Surface cleaning with dry cloth or cloth dipped in soapy water.

Do not use acetone, tar remover or trichloroethylene.

**Caution:** A test should be carried out before using any specific cleaners.

## 7. ACCESSORIES

For indicator (orange) or locator (green) functions

0 694 96: 230 V - 1 mA green only for single push-button with locator

0 694 97: 230 V - 0.5 mA green

0 694 98: 230 V - 1 mA orange

0 694 99: 12 V - 15 mA green

0 694 95: 24 V - 20 mA green

## 8. STANDARDS AND APPROVALS

Compliance with standards of installation and manufacturing.

Refer to e. catalogue.

# Plexo™ Push-buttons

Cat. No(s): 0 695 39/40/41/42/43/44/45/46 - 0 696 30/31/32/33/34/35/36  
 0 697 20/22/23/24/25/29/60/62/64/65/69  
 0 698 21/22/24/25/61/62/64/65

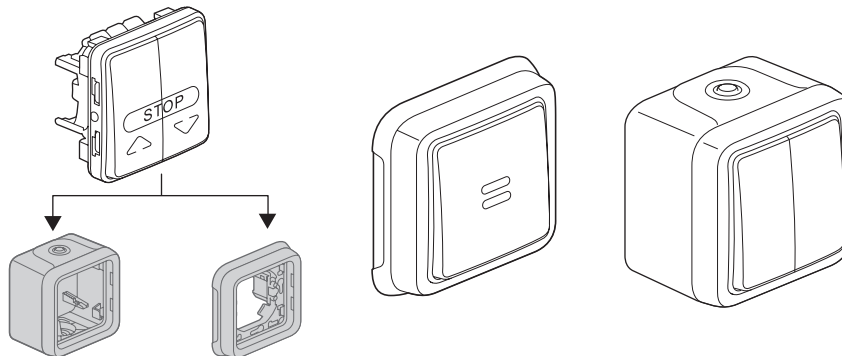

## 1. USE

Weatherproof wiring devices system intended for residential and professional technical premises (garages, cellars, car parks, workshops and industrial kitchens, etc.) as well as outdoor environments (patios, terraces, gardens, camping sites, etc.).  
 Lighting control mechanisms with or without indicating (lights) or signalling (marking) components.  
 All illuminated or pilot light products are supplied with their lamps fitted.

## 2. RANGE

2 versions : grey and white		References
<b>Configurable</b>		0 695 39/40/41/42/43/44/45/46 0 696 30/31/32/33/34/35/36
<b>Surface-mounting complete</b>		0 697 20/22/23/24/25/29 0 697 60/62/64/65/69
<b>Flush-mounting complete</b>		0 698 21/22/24/25 0 698 61/62/64/65

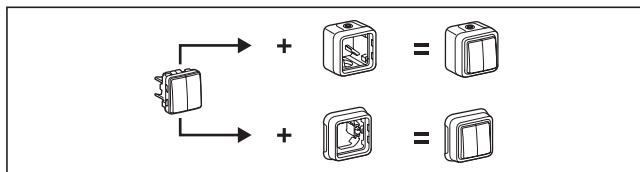

## 3. PREPARATION

### 3.1 Surface-mounting

- By screwing the base box onto the support using 2 screws Ø 3-4 mm max.

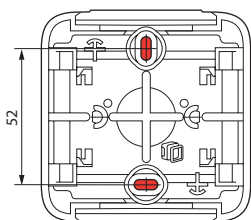

## 3. PREPARATION (continued)

### 3.2 Flush-mounting

- Frame dismantling

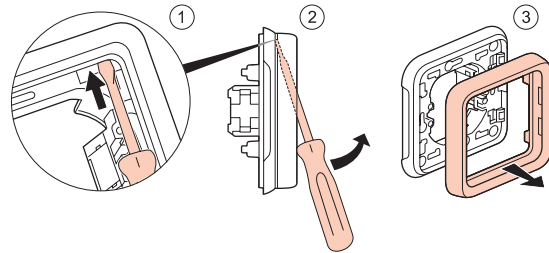

- By screwing onto a flush-mounting box

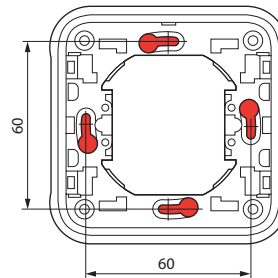

- By claws onto a flush-mounting box

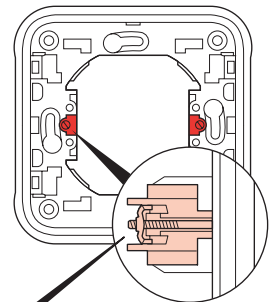

Possibility to place claws:  
 Cat. No. 0 849 00 or Cat. No. 0 849 01 (long claw)

- By face plate using 4 screws Ø 4 mm

Piercing of support material for diameter 60-70 mm using cylinder saw or punch.

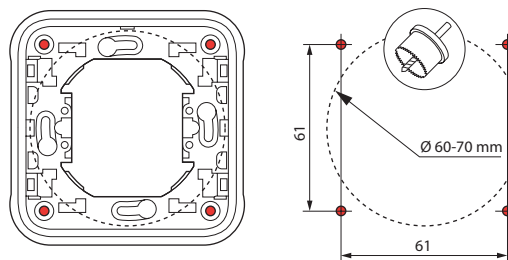

#### 4. OVERALL DIMENSIONS (mm)

##### ■ Configurable

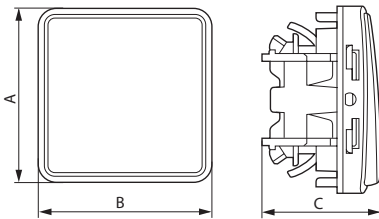

##### ■ Surface-mounting

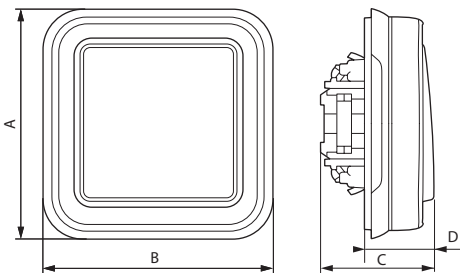

##### ■ Flush-mounting

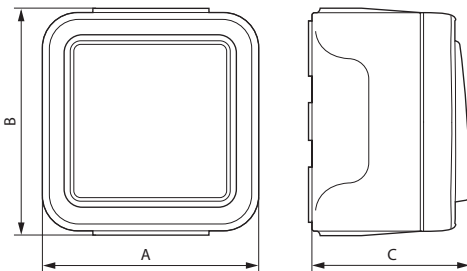

	A	B	C	D
<b>Configurable</b>	64	64	40	-
<b>Surface-mounting</b>	84	80	57	-
<b>Flush-mounting</b>	86	86	42	23

#### 5. CONNECTION

##### ■ Connection to conductors

• 1 break

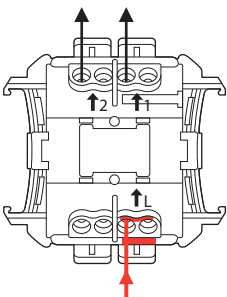

• 2 breaks

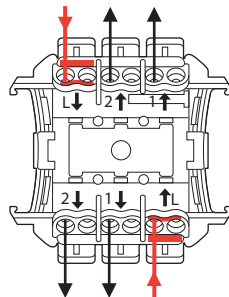

#### 5. CONNECTION (continued)

##### ■ Connection to conductors

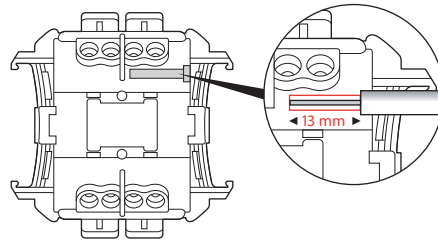

Type of terminals: automatic  
Terminal capacity: 1.5 mm<sup>2</sup> - 2.5 mm<sup>2</sup> (1 or 2 conductors)  
Stripping length: 13 mm

#### 6. TECHNICAL CHARACTERISTICS

##### ■ 6.1 Protection index

Protection against solid bodies and liquids: IP 55  
Protection against impact: IK 07

##### ■ 6.2 Material characteristics

Box, support: PP (reinforced polypropylene)  
Front plate, rocker: ABS  
Entry gland, cover plate: PP + SEBS  
Mechanism: PC

UV resistant

Resistance to salt spray: 7 days (168 h)

Self-extinguishing:

+ 850°C / 30 s for insulating components holding in place live parts.  
+ 650°C / 30 s for the other insulating components.

##### ■ 6.3 Electrical characteristics

Current: 10 A  
Voltage: 250 V~  
Frequency: 50 Hz

##### ■ 6.4 Climatic characteristics

Storage temperature: - 25° C to + 70° C  
Use temperature: - 25° C to + 40° C

#### 7. CLEANING

Surface cleaning with dry cloth or cloth dipped in soapy water.  
Do not use acetone, tar remover or trichloroethylene.

**Caution:** A test should be carried out before using any specific cleaners.

#### 8. STANDARDS AND APPROVALS

Compliance with standards of installation and manufacturing.  
Refer to e. catalogue.

**Plexo™**  
**2 P+E socket outlets - British Standard**

Cat. No(s): 0 695 85 - 0 697 32/39

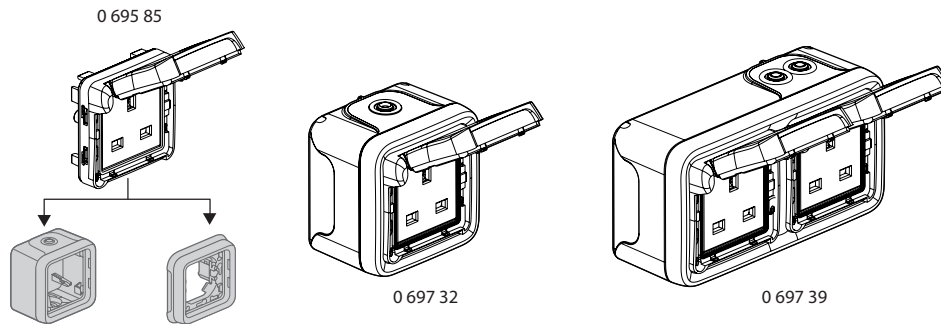

**1. USE**

2 P+E socket outlets with shutters.  
 Waterproof electrical equipment for residential and professional technical installations (garages, cellars, car parks, workshops, industrial kitchens, etc.) and outdoor environments (terraces, gardens, camp sites, etc.).

**2. RANGE**

version : grey	References
<b>Configurable</b>	0 695 85
<b>Surface-mounting complete</b>	0 697 32 0 697 39

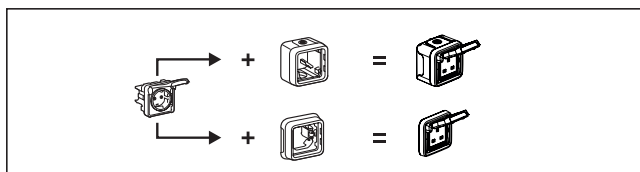

**3. INSTALLATION**

**3.1 Surface mounting**

- Back body is mounted on the support using two screws, max. Ø 3 to 4 mm.

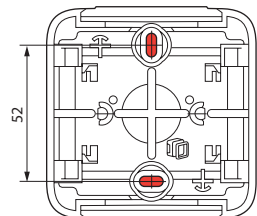

**3.2 Flush mounting (continued)**

**3.2 Flush mounting**  
 - Frame dismantling

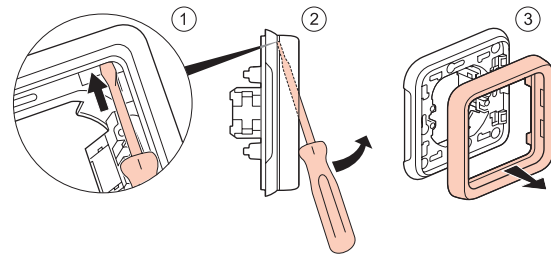

- By screwing onto a flush-mounting box

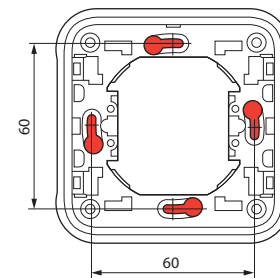

- By claws onto a flush-mounting box

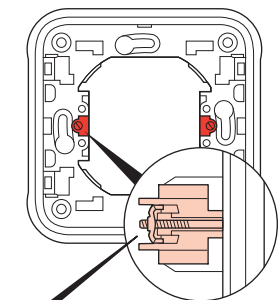

Possibility to place claws:  
 Cat. No. 0 849 00 or Cat. No. 0 849 01 (long claw)

- Screw-mounted in flush-mounting box.

- Mounting on base plate using 4 screws, Ø 4 mm.

Opening cut in base-plate, Ø 60 - 70 mm using a circular saw or a punch

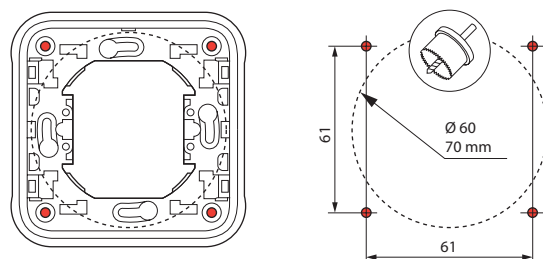

#### 4. CONNECTION

##### ■ Connection to conductors

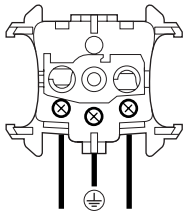

Type of terminals: with screws  
 Terminal capacity: 2 x 4 mm<sup>2</sup>.  
 Screwdriver required: flat blade 2 to 4 mm.  
 Stripping length: 9 mm.

#### 5. DIMENSIONS (mm)

Composable

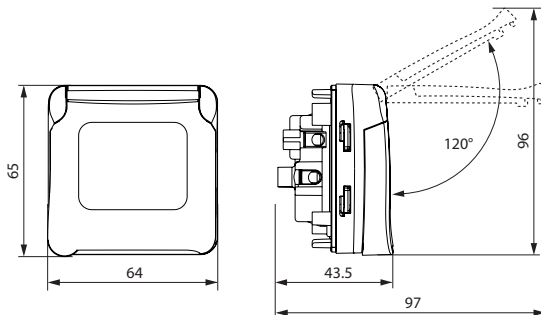

Surface mounting

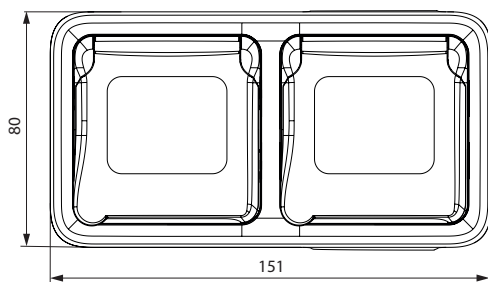
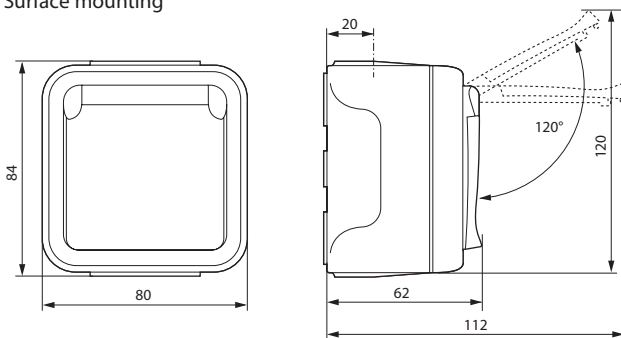

Flush-mounting

#### 6. GENERAL CHARACTERISTICS

##### ■ 6.1 Protection index (shutter closed)

Protection against solid bodies and liquids: IP 55  
 Protection against impact: IK 07

##### ■ 6.2 Material characteristics

Box, support: PP (filled Polypropylene)  
 Plate, flap: ABS  
 Entry gland: PP + SEBS  
 Mechanism: PC

#### 6. GENERAL CHARACTERISTICS (continued)

UV resistant.  
 Resistance to salt spray: 7 days (168 h)

Self-extinguishing:  
 + 850°C / 30 s for insulating components holding in place live parts.  
 + 650°C / 30 s for the other insulating components.

##### ■ 6.3 Electrical characteristics

Current: 13 A  
 Voltage: 250 V~  
 Frequency: 50 Hz

##### ■ 6.4 Climatic characteristics

Storage temperature: - 25° C to +70° C  
 Use temperature: - 25° C to + 40° C

#### 7. CLEANING

Surfaces may be cleaned using a cloth, either dry or with soapy water.  
 Do not use acetone, spirits or trichloroethylene.

**Caution:** Conduct preliminary tests before using any specific cleaning product.

#### 8. COMPLIANCES AND APPROVALS

Compliance with standards of installation and manufacturing.  
 Refer to e.catalogue.